

A 351

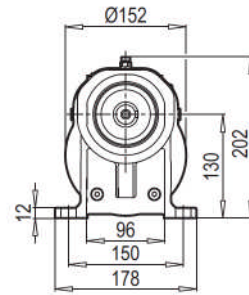

AF-M 351

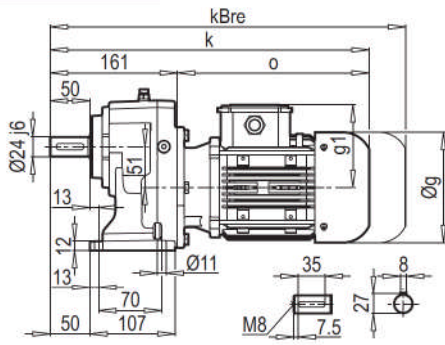
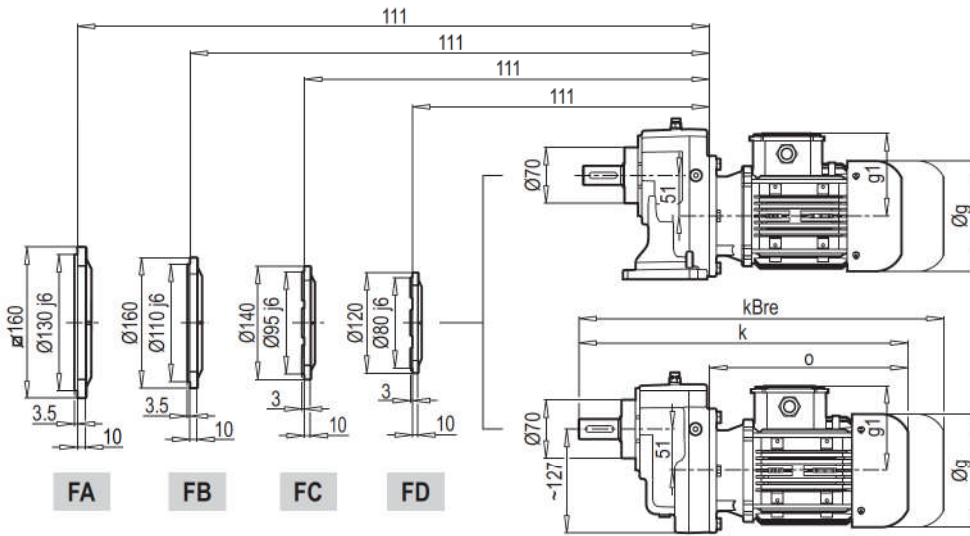
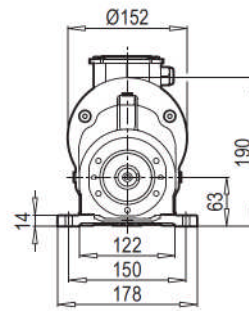
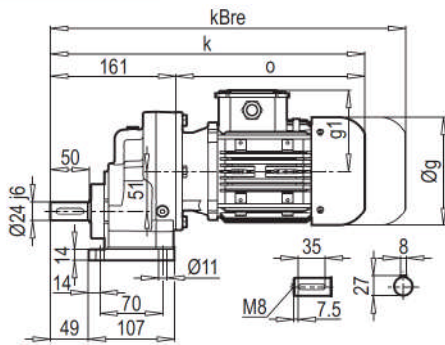

AF 351

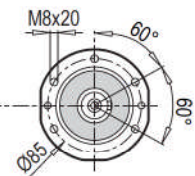

F 351

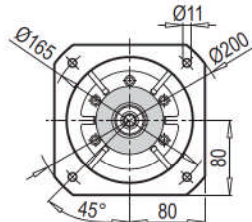
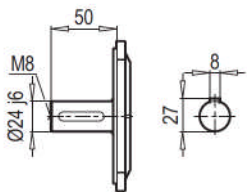

FA

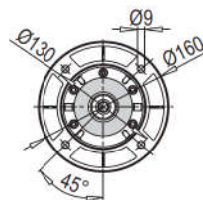

FB

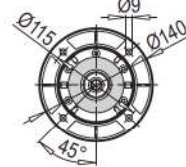

FC

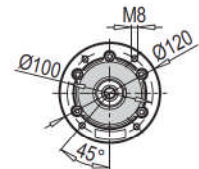

FD

	71 M	80 M	90 S	90 L	100 L	112 M		
g	140	159	193	193	217	232		
g1	119	127	151	151	160	168		
k	402	428	474	494	495	554		
kBre	462	490	547	567	576	634		
o	241	267	313	333	334	393		

A 351 PAM B5/B14

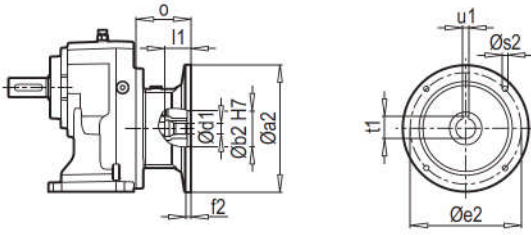

A 351 W

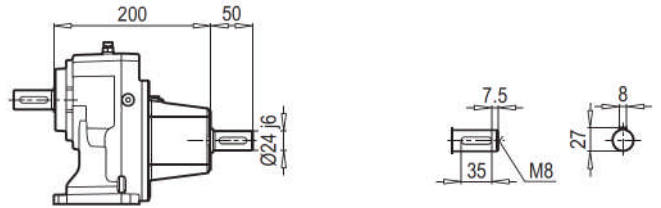

F 351 PAM B5/B14

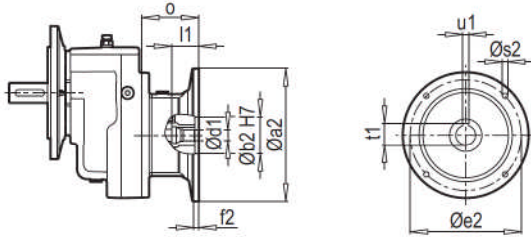

F 351 W

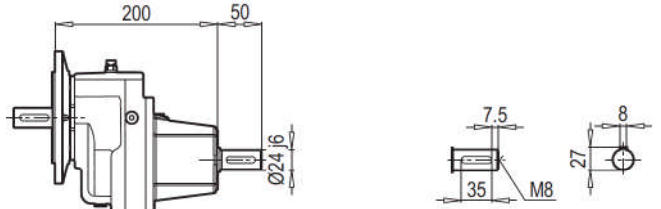

AF 351 PAM B5/B14

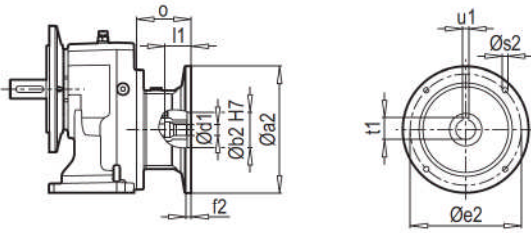

AF 351 W

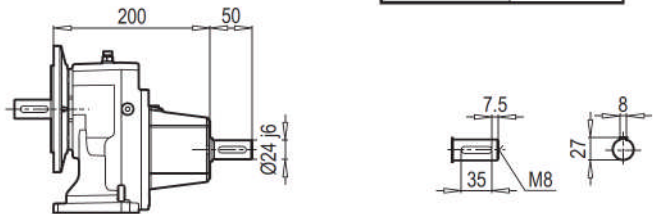

W ~ Kg	
A/F 351	12

AF-M 351 PAM B5/B14

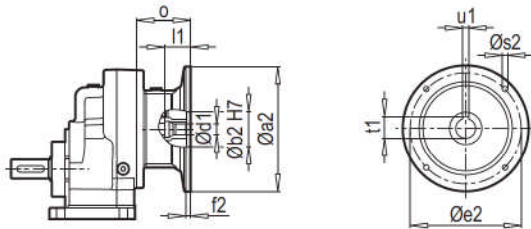

AF-M 351 W

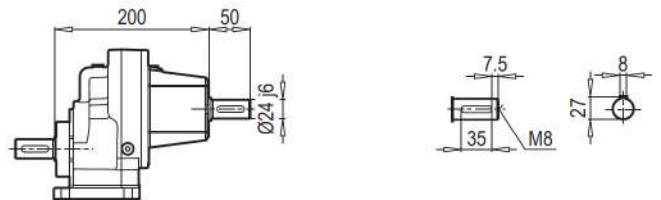









Tip / Type Typ / Tipo Type / Tipo	PAM B5	Øa2	Øb2	Øe2	f2	Øs2	Ød1	l1	t1	u1	o
A/F 351	71	160	110	130	5	M8	14	32	16.3	5	69
	80	200	130	165	5	M10	19	42	21.8	6	90
	90	200	130	165	5	M10	24	52	27.3	8	90
	100	250	180	215	5.5	M12	28	62	31.3	8	105
	112	250	180	215	5.5	M12	28	62	31.3	8	105

~ Kg	
PAM B5	A/F 351
71	8
80	8.5
90	8.5
100	13
112	13

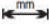
Tip / Type Typ / Tipo Type / Tipo	PAM B14	Øa2	Øb2	Øe2	f2	Øs2	Ød1	l1	t1	u1	o
A/F 351	71	105	70	85	2.5	7	14	32	16.3	5	69
	80	120	80	100	3	7	19	42	21.8	6	90
	90	140	95	115	3	9	24	52	27.3	8	90
	100	160	110	130	3.5	9	28	62	31.3	8	105
	112	160	110	130	3.5	9	28	62	31.3	8	105

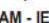
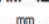
~ Kg	
PAM B14	A/F 351
71	7
80	7.5
90	7.5
100	9.5
112	9.5

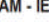
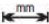
Tip / Type / Typ / Tipo / Type / Tipo	iges	4-pol 50Hz 1400rpm n2 [min-1]	Mamax f _B =1 4 - pol. [Nm]	P _{1max} W f _B ≥ 1		PAM - IEC									
				4 - pol. 1400rpm [kW]	FR1 [kN]	FR2 [kN]	f _B →  39 - 107								
A353 F353 W   123 + PAM - IEC   123	268.00	5.2	500	0.27	1.4	8.0	63	71							
	216.67	6.5	500	0.34	1.3	8.0	63	71							
	194.72	7.2	500	0.38	1.3	8.0	63	71							
	157.42	8.9	500	0.47	1.3	8.0	63	71							
	134.76	10.4	500	0.54	1.3	8.0	63	71	80	90					
	108.95	12.9	500	0.67	1.3	8.0	63	71	80	90					
	90.51	15.5	500	0.81	1.3	8.0	63	71	80	90					
	72.58	19.3	500	1.01	1.2	8.0	63	71	80	90					
58.68	23.9	500	1.25	1.2	8.0	63	71	80	90						
A352 F352 W   123 + PAM - IEC   123	56.95	24.6	490	1.26	1.2	8.0	71	80	90						
	49.88	28.1	490	1.44	1.1	8.0	71	80	90						
	46.04	30.4	490	1.56	1.1	8.0	71	80	90						
	39.59	35.4	490	1.81	1.1	8.0	71	80	90	100	112				
	33.50	41.8	490	2.14	1.0	8.0	71	80	90						
	32.01	43.7	490	2.24	1.0	8.0	71	80	90	100	112				
	28.89	48.5	490	2.49	1.0	7.9	71	80	90	100	112				
	26.59	52.6	490	2.70	0.9	7.6	71	80	90	100	112				
	25.13	55.7	470	2.74	0.9	7.5	71	80	90	100	112				
	22.03	63.6	470	3.13	0.9	7.1	71	80	90	100	112				
	20.31	68.9	460	3.32	0.8	6.9	71	80	90	100	112				
	18.30	76.5	460	3.68	0.8	6.5	71	80	90	100	112				
	16.88	83.0	450	3.91	0.7	6.3	71	80	90	100	112				
	14.52	96.4	430	4.34	0.6	6.0		80	90	100	112				
	11.74	119.3	390	4.87	0.6	5.7		80	90	100	112				
	9.75	143.6	370	5.56	0.4	5.3		80	90	100	112				
8.73	160.4	340	5.71	0.4	5.2		80	90	100	112					
7.06	198.4	290	6.02	0.3	5.1		80	90	100	112					
5.86	238.8	260	6.50	0.3	4.8		80	90	100	112					
A351 F351 W   121 + PAM - IEC   121	8.50	164.7	100	1.72	1.2	2.5	71	80	90						
	7.44	188.1	100	1.97	1.1	2.5	71	80	90						
	5.91	236.9	100	2.48	1.1	2.3	71	80	90	100	112				
	5.33	262.5	100	2.75	1.0	2.2	71	80	90	100	112				
	4.85	288.9	95	2.87	1.0	2.2	71	80	90	100	112				
	4.07	344.3	90	3.24	1.0	2.0	71	80	90	100	112				
	3.75	373.3	90	3.52	1.0	2.0	71	80	90	100	112				
	3.22	434.5	80	3.64	0.9	1.9	71	80	90	100	112				
	2.62	534.5	70	3.92	0.9	1.8	71	80	90	100	112				
	2.17	646.2	60	4.06	0.9	1.7		80	90	100	112				
1.45	964.4	60	6.06	0.6	1.5		80	90	100	112					
1.30	1074.4	40	4.50	0.8	1.5		80	90	100	112					

PAM - IEC bağlantısı yoktur - No PAM - IEC assembling on empty fields

63 PAM - IEC bağlantısı yapılır - PAM - IEC assembling available on numbered fields