

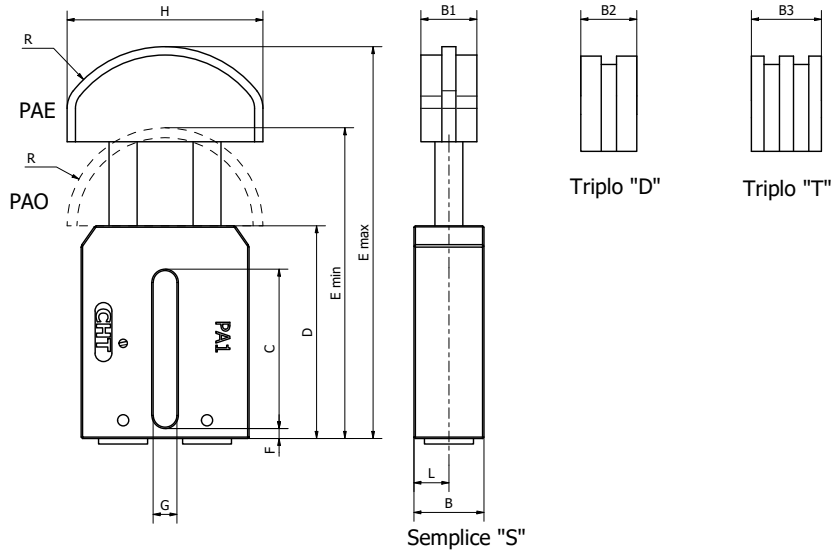

LINEAR CHAIN TENSIONER IN POLYAMIDE CHT - PAE - PAO

- Base structure made of polyamide 66 FV 50.
- Available with Stainless Steel springs, studs, plugs and washers.
- CHT-PA tensioner element with a high-density polyethylene slider block set up on the pins of the base structure.



CAD drawings available on www.chiaravalli.com
Availability, quantity and prices on B2B Chiaravalli

Type	Part Num. simple	Part Num. double	Part Num. triple	Newton	Chain pitch	A	B	C	D	E	E Min	F	G	H	L	B1	B2	B3	R	Weight kg.
PAE 1	94PAE138S	94PAE138D	94PAE138T	210	3/8"	60	25	56	76	140	110	4	8,5	70	12,5	20	20	25	42	0,21
PAO 1	94PAO138S	94PAO138D	94PAO138T	210	3/8"	60	25	56	76	140	110	4	8,5	70	12,5	20	20	25	35	0,21
PAE 1	94PAE112S	94PAE112D	94PAE112T	210	1/2"	60	25	56	76	140	110	4	8,5	70	12,5	20	20	35	42	0,21
PAO 1	94PAO112S	94PAO112D	94PAO112T	210	1/2"	60	25	56	76	140	110	4	8,5	70	12,5	20	20	35	35	0,21
PAE 1	94PAE158S	94PAE158D	94PAE158T	210	5/8"	60	25	56	76	140	110	4	8,5	70	12,5	20	25	40	50	0,21
PAO 1	94PAO158S	94PAO158D	94PAO158T	210	5/8"	60	25	56	76	140	110	4	8,5	70	12,5	20	25	40	35	0,21

