

A/F 301

A 301

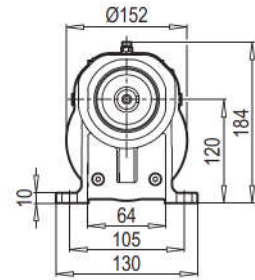

AF-M 301

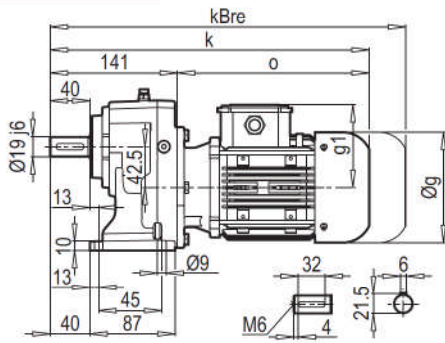
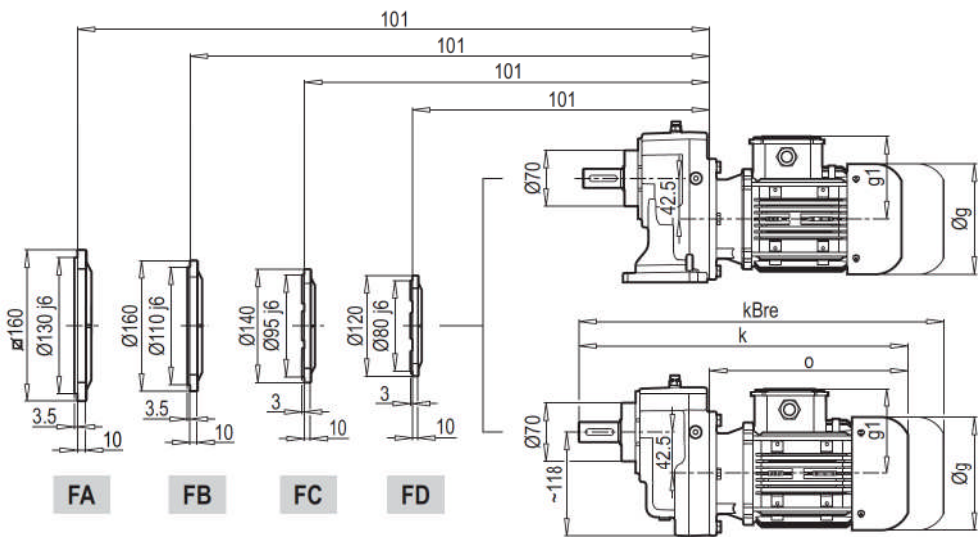
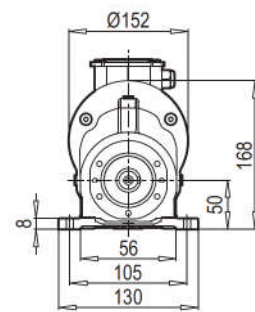
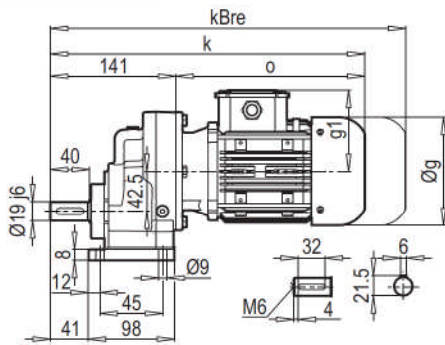

AF 301

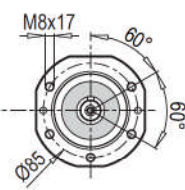

F 301

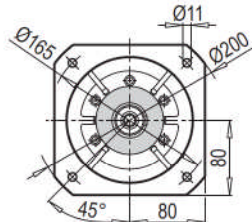
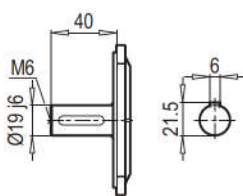

FA

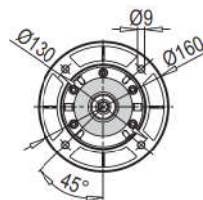

FB

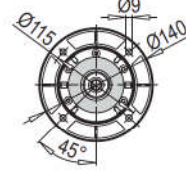

FC

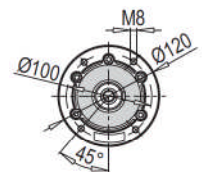

FD

	71 M	80 M	90 S	90 L				
g	140	159	193	193				
g1	119	127	151	151				
k	382	408	454	474				
kBre	442	470	527	547				
o	241	267	313	333				

A 301 PAM B5/B14

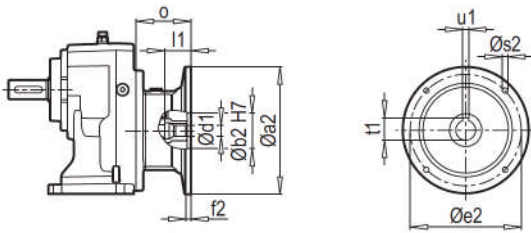

A 301 W

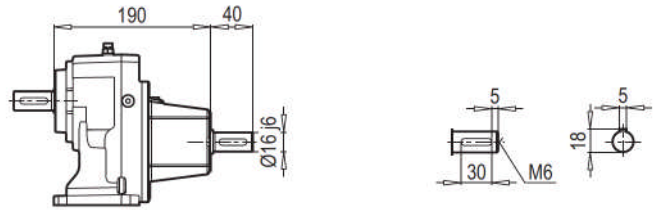

F 301 PAM B5/B14

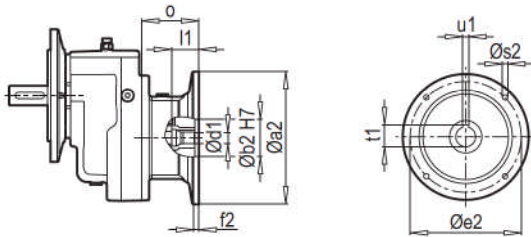

F 301 W

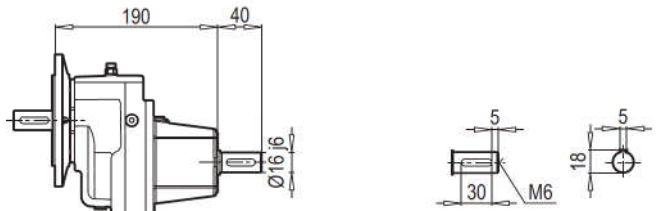

AF 301 PAM B5/B14

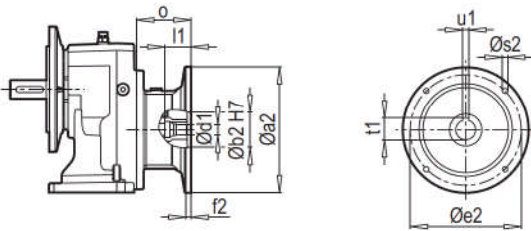

AF 301 W

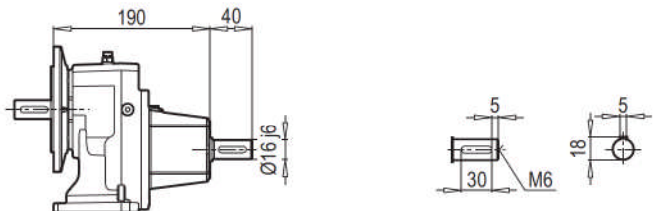

W ~ Kg	
A/F 301	10

AF-M 301 PAM B5/B14

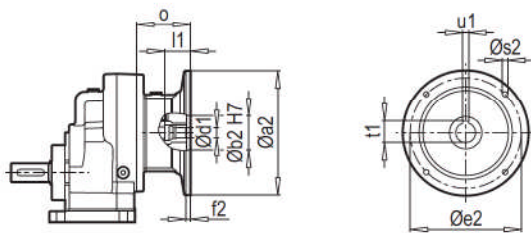

AF-M 301 W

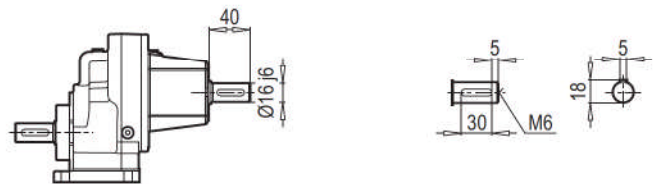













Tip / Type Typ / Tipo Type / Tipo	PAM B5	Øa2	Øb2	Øe2	f2	Øs2	Ød1	l1	t1	u1	o
A/F 301	71	160	110	130	5	M8	14	32	16.3	5	69
	80	200	130	165	5	M10	19	42	21.8	6	90
	90	200	130	165	5	M10	24	52	27.3	8	90

~ Kg	
PAM B5	A/F 301
71	6
80	6.5
90	6.5

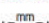
Tip / Type Typ / Tipo Type / Tipo	PAM B14	Øa2	Øb2	Øe2	f2	Øs2	Ød1	l1	t1	u1	o
A/F 301	63	90	60	75	2.5	6	11	32	16.3	5	69
	71	105	70	85	2.5	7	14	42	21.8	6	90
	80	120	80	100	3	7	19	52	27.3	8	90

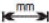
~ Kg	
PAM B14	A/F 301
63	5
71	5.5
80	5.5

W - IEC - PAM

Tip / Type / Typ / Tipo / Type / Tipo	iges	4-pol 50Hz 1400rpm n2 [min-1]	Mamax f _B =1 4 - pol. [Nm]	P _{1max} W f _B ≥ 1			PAM - IEC							
				4 - pol. 1400rpm [kW]	FR1 [kN]	FR2 [kN]	f _B →  39 - 107							
A303 F303 W   119 + PAM - IEC   119	282.17	5.0	300	0.16	1.4	6.6	63	71						
	227.56	6.2	300	0.19	1.4	6.6	63	71						
	205.01	6.8	300	0.21	1.4	6.6	63	71						
	165.33	8.5	300	0.27	1.4	6.6	63	71						
	141.89	9.9	300	0.31	1.4	6.6	63	71	80	90				
	125.65	11.1	300	0.35	1.3	6.6	63	71						
	114.42	12.2	300	0.38	1.3	6.6	63	71	80	90				
	86.96	16.1	300	0.51	1.3	6.6	63	71	80	90				
	76.42	18.3	300	0.58	1.3	6.6	63	71	80	90				
	61.63	22.7	300	0.71	1.3	6.6	63	71	80	90				
A302 F302 W   119 + PAM - IEC   119	55.03	25.4	280	0.75	1.3	6.6	71	80	90					
	48.22	29.0	280	0.85	1.2	6.6	71	80	90					
	44.38	31.5	280	0.93	1.2	6.6	71	80	90					
	38.33	36.5	280	1.07	1.2	6.6	71	80	90					
	34.62	40.4	280	1.19	1.2	6.6	71	80	90					
	30.91	45.3	280	1.33	1.1	6.6	71	80	90					
	27.92	50.1	280	1.47	1.1	6.6	71	80	90					
	26.45	52.9	260	1.44	1.1	6.6	71	80	90	100	112			
	23.49	59.6	260	1.62	1.0	6.3	71	80	90					
	21.33	65.6	250	1.72	1.0	6.1	71	80	90	100	112			
	19.29	72.6	250	1.90	1.0	5.8	71	80	90	100	112			
	16.21	86.3	250	2.26	0.9	5.4	71	80	90	100	112			
	13.81	101.4	250	2.65	0.8	5.0	71	80	90	100	112			
	12.00	116.7	250	3.05	0.7	4.7	71	80	90	100	112			
	10.50	133.4	240	3.35	0.6	4.5	71	80	90	100	112			
	9.11	153.7	210	3.38	0.6	4.4	71	80	90	100	112			
7.34	190.6	160	3.19	0.7	4.4	71	80	90	100	112				
5.58	250.8	160	4.20	0.4	3.9	71	80	90	100	112				
A301 F301 W   117 + PAM - IEC   117	8.88	157.7	55	0.91	1.2	1.0	71	80	90					
	7.78	180.0	50	0.94	1.2	1.0	71	80	90					
	6.18	226.5	50	1.19	1.2	0.9	71	80	90					
	5.58	250.7	50	1.31	1.2	0.9	71	80	90					
	5.08	275.8	45	1.30	1.2	0.9	71	80	90					
	4.27	328.1	45	1.55	1.1	0.8	71	80	90					
	3.65	383.9	45	1.81	1.1	0.8	71	80	90					
	3.16	443.3	40	1.86	1.1	0.7	71	80	90					
	2.76	506.9	30	1.59	1.1	0.7	71	80	90					
	2.59	540.4	30	1.70	1.1	0.7	71	80	90					
2.04	686.8	25	1.80	1.1	0.7	71	80	90						
1.47	953.2	25	2.50	1.0	0.6	71	80	90						

PAM - IEC bağlantısı yoktur - No PAM - IEC assembling on empty fields

63 PAM - IEC bağlantısı yapılır - PAM - IEC assembling available on numbered fields